

PARKING  
60'4 x 33'4  
18.40m x 10.15m

REAR GARDEN  
104'1 x 38'9  
31.73m x 11.80m

UTILITY ROOM  
16'4 x 7'2  
4.97m x 2.18m

PATIO  
29'6 x 27'9  
9.00m x 8.47m

BEDROOM  
17'2 x 10'11  
5.22m x 3.34m

KITCHEN  
12'6 x 8'10  
3.82m x 2.70m

FAMILY/DINING ROOM  
29'10 x 11'3  
9.10m x 3.42m

LOUNGE  
18'1 x 13'8  
5.50m x 4.16m

FRONT GARDEN  
55'11 x 37'5  
17.05m x 11.40m

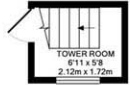

2ND FLOOR  
APPROX. FLOOR  
AREA 39 SQ. FT.  
(3.6 SQ.M.)

BEDROOM  
16'11 x 10'11  
5.15m x 3.34m



BEDROOM  
11'11 x 11'3  
3.63m x 3.44m

BEDROOM  
15' x 9'  
4.56m x 2.74m



BEDROOM  
18'8 x 11'3  
5.68m x 3.44m

BEDROOM  
15'7 x 13'7  
4.76m x 4.14m

1ST FLOOR  
APPROX. FLOOR  
AREA 1102 SQ. FT.  
(102.4 SQ.M.)



GROUND FLOOR  
APPROX. FLOOR  
AREA 1126 SQ. FT.  
(104.6 SQ.M.)

REF: BURY TOWER  
TOTAL APPROX. FLOOR AREA 2267 SQ. FT. (210.6 SQ.M.)

© Harrington Holiday Homes